

Sacramento Campus On the Move

Join us in praying as we approach our relocation in the coming months!

Weekly

Pray for Students

- Pray for safety in this new location and the building's impact on current and future ministry.
- Pray for students impacted by the increased distance of the campus's move to the Northeast.
- Pray that God graciously provides opportunities for local free or cheap housing.
- Pray that this might be both a sanctuary and a learning center for those seeking to transform the world with the gospel of Jesus in urban, suburban, and rural settings, both locally and worldwide.
- Pray that students would be both challenged and comforted at the Sacramento Campus.
- Pray that students would forge lifelong connections with one another.
- Pray that students would build relationships with faculty from all over the country in a rich way.

Feb./Mar. 3-7

Pray for Alumni

- Pray that God would use this move to form and reform connections to Western Seminary, and that our campus might be a support and an encouragement to alumni.
- Pray that the Sacramento Campus might be a resource for alumni to further trustworthy and accessible training, to be refreshed in new relationships, and to experience greater gospel-centered transformation in their lives and in their respective communities.
- Pray that God would increase the fruitfulness of the current ministry of our alumni as they further the gospel of Jesus to the ends of the earth.
- Pray that God would alert alumni to the love and support of Western Seminary beyond their current ministries.

Feb./Mar. 10-14

Pray for Move

- Pray for expedient timing on construction and permits.
- Pray for donor support necessary to help furnish and develop the campus for greater facilitation of faithful, innovative, and advanced training for strategic ministry roles.
- Pray for a seamless install of the various upgraded technology, including security systems, wireless access, and communication across all three Western Campuses.
- Pray that deliveries and purchases are both promptly executed and negotiated well.
- Pray for increased opportunities for regional vendor relationships.

Feb./Mar. 17-21

Pray for Community

- Pray that God will facilitate deep and fruitful relationships with regional churches and other nearby universities.
- Pray for greater synergy with like-minded institutions, including radio stations, businesses, schools and churches.
- Pray that Western Seminary would be a source of unity between churches in the Sacramento area.
- Pray that God would provide new potential counseling opportunities and support to community and churches.
- Pray for Western's burgeoning coaching program and its impact on community businesses and people.
- Pray for the proclamation of the gospel of Jesus in the Sacramento region via the testimony of students and others connected to Western.
- Pray for the spiritual health and growth of the community at Creekside Church, for their relationship with Western Seminary, and for their impact in the city of Rocklin.

Feb./Mar. 24-29

Pray for Faculty and Staff

- Pray for the discovery and continued development of high-quality, gospel-centered faculty.
- Pray for faculty as they adjust to the transition of a midsemester campus relocation.
- Pray that new and returning faculty join in our vision of God's movement through Western via this new campus location.
- Pray for comfort, encouragement and patience for those staff members shouldering much of the work of relocation and transition.
- Pray for increased enablement of the support staff—including admissions, student services, library services, counseling administrators, and executive staffers—to provide high quality training and better service in the weeks, months, and years to come.



**WESTERN
SEMINARY**
Sacramento Campus

NEW CAMPUS PRELIMINARY LAYOUT

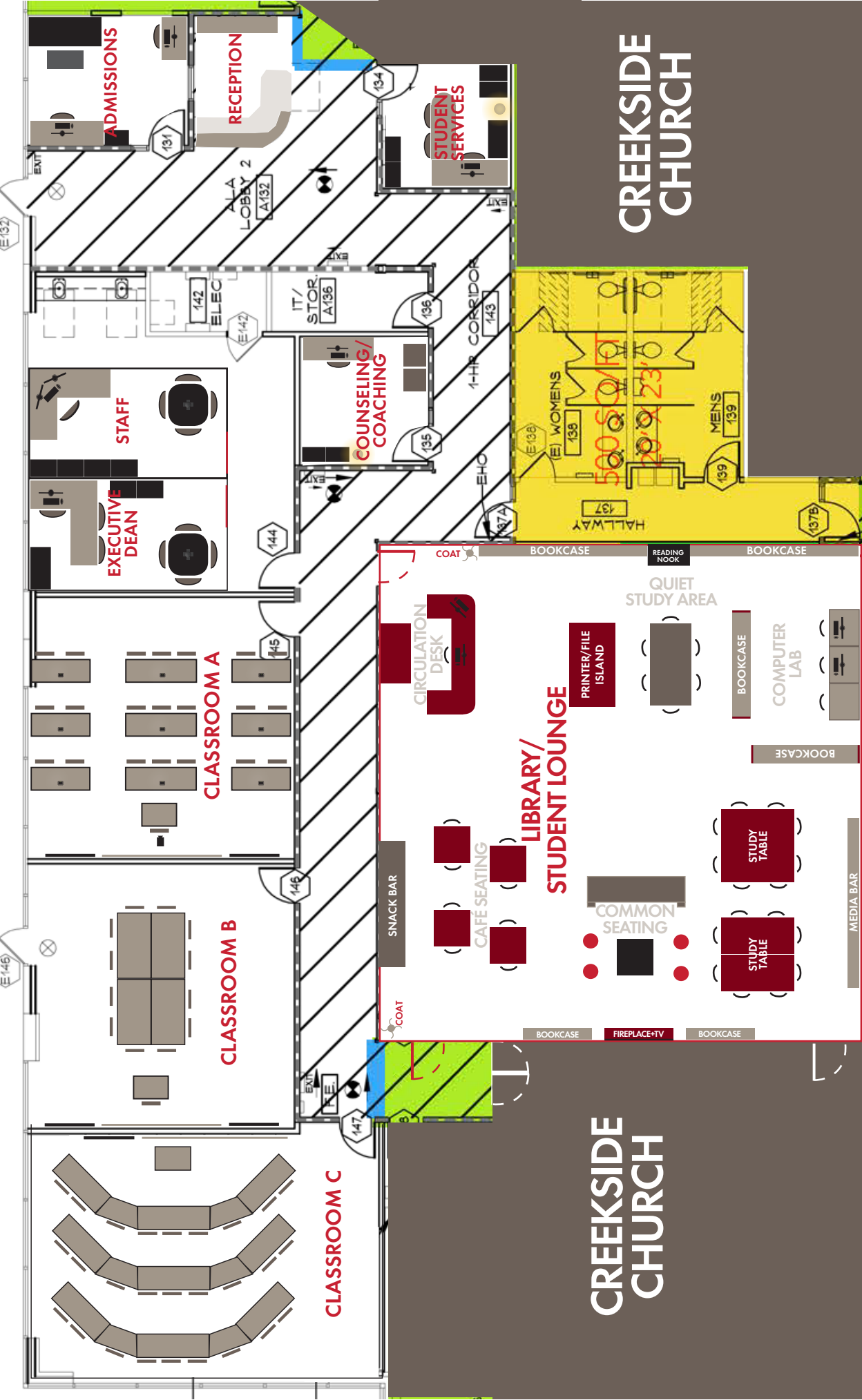

**CREEKSIDE
CHURCH**

**CREEKSIDE
CHURCH**